

**THULE**<sup>®</sup>  
SWEDEN

# ➤ Instructions

**Thule Evo Raised Rail**  
710405

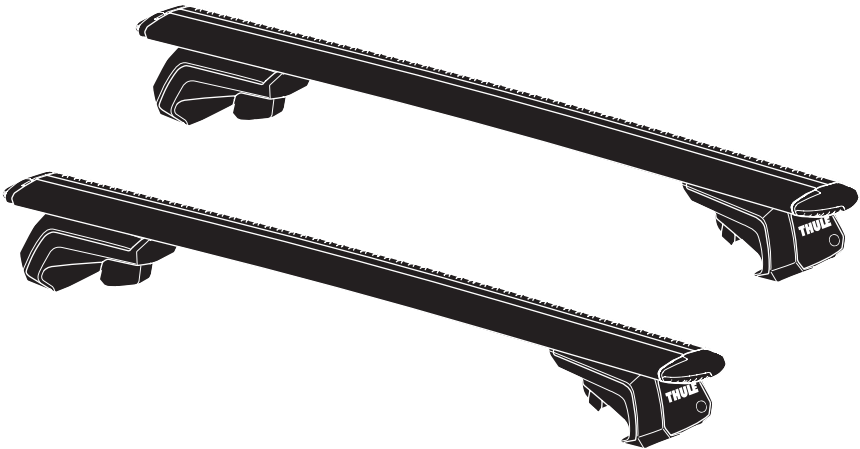

5560446001

**Bring your life**  
thule.com

**EN** Roof mounted load carrier  
**DE** Lastenträger zur Dachmontage  
**FR** Barre de toit  
**NL** Dakdrager  
**IT** Barra portatutto da installare sul tetto  
**ES** Portaequipajes de techo  
**PT** Barra para montagem no tejadilho  
**SV** Takmonterad lasthållare  
**DK** Tagmonteret lastholder  
**NO** Takmontert lasteholder  
**FI** Katolle asennettava teline  
**ET** Katusele paigaldatav katuseraam  
**LV** Uz jumta uzstādāms kravas turētājs  
**LT** Ant stogo tvirtinamas krovinių laikiklis  
**PL** Uchwyt na bagażnik bazowy montowany na dachu  
**RU** Багажник на крышу  
**UK** Багажник для даху  
**BG** Багажник, монтиран върху покрива  
**CS** Nosič pro montáž na střechu

**SK** Strešný nosič  
**SL** Nosilec za strešni prtljažnik  
**HR/BIH** Krovni nosač tereta  
**RO** Suport încărcătură montat pe acoperiș  
**HU** Tetőre szerelhető csomagszállító  
**EL** Σχάφρα οροφής για μεταφορά φορτίου  
**TR** Araç üstüne bağlanan yük taşıyıcı

**HE** מנשא מטען לגג הרכב  
**AR** حامل نفل مثبت على السقف

**ZH** 顶置行李架  
**JA** ルーフマウント型ロードキャリア  
**KO** 루프 장착 화물 캐리어  
**TH** โครงยึดของบรรทุกแบบติดตั้งบนหลังคา

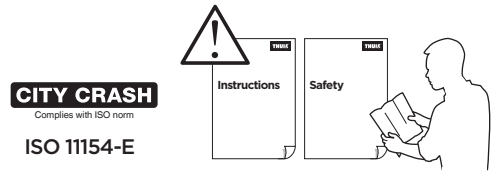

80 km/h  
50 Mph

5 kg / 11 lbs  
 4 kg / 8,8 lbs + 5,5 kg / 12,1 lbs  
 1,8 kg / 4 lbs  
**Max. 100 kg / 220,5 lbs**

**i** Your Key-Number

## >Mounting Tutorial

Thule Evo Raised Rail



thule.com

**2**  
FOOT PACK

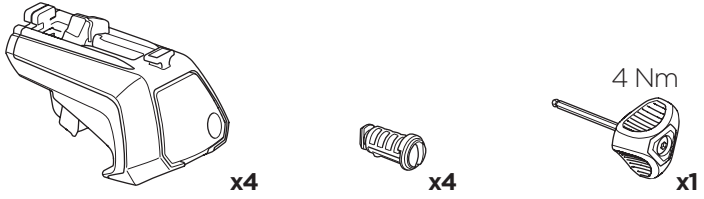

**3**  
BAR

**THULE WingBar Evo**

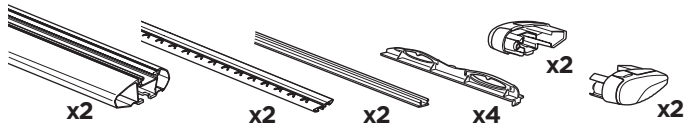

**THULE AeroBlade**

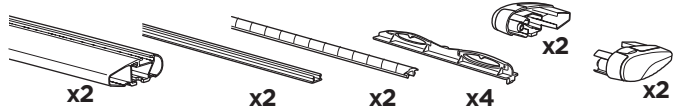

**THULE ProBar Evo**

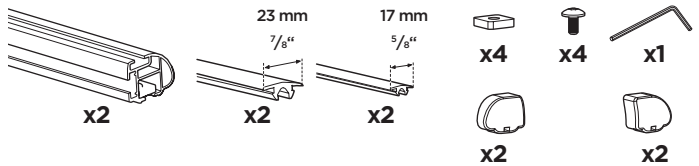

**THULE SquareBar Evo**

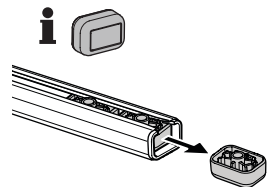
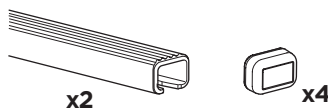

1

BAR

3

THULE  
WingBar Evo

A

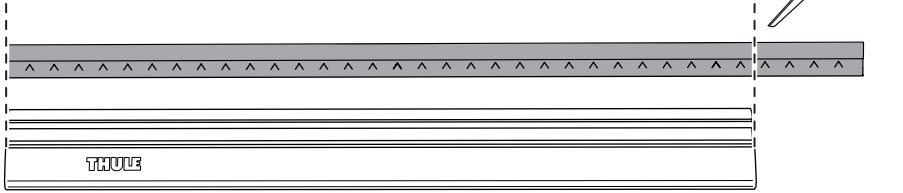

B

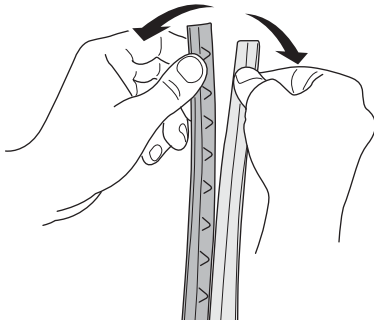

C

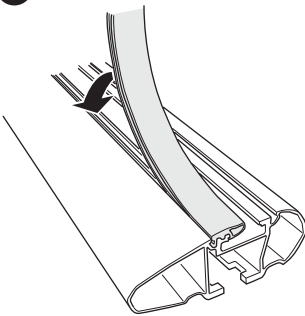

D

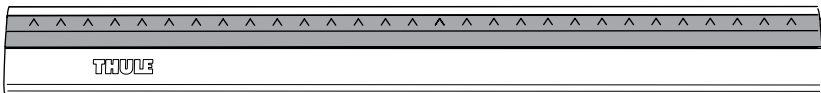
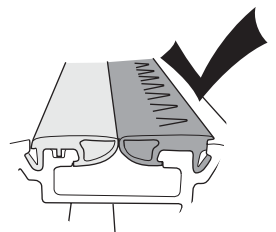
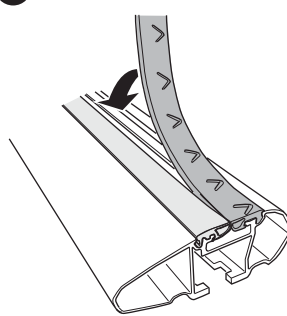

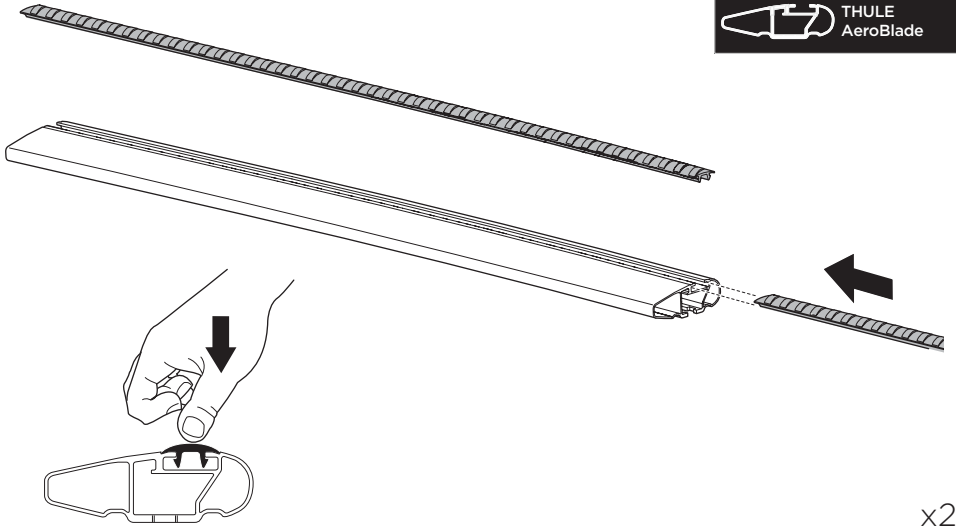

x2

2



A



B



C

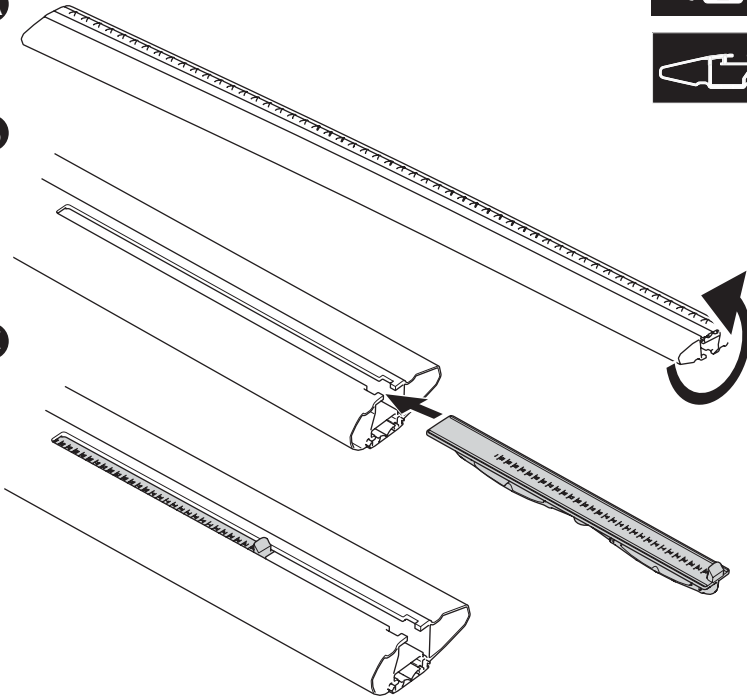

x4

3

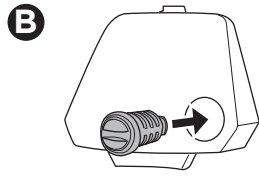
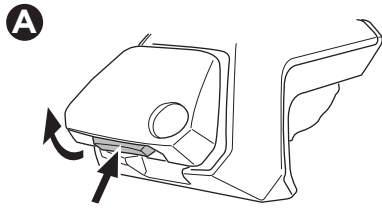

x4

**i**

Accessory

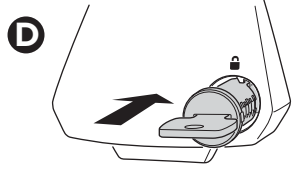
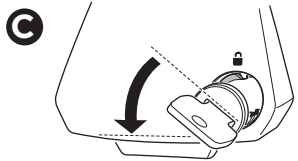
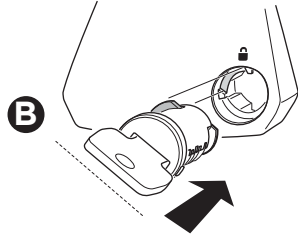
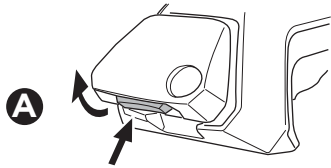
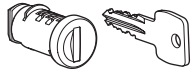

x4

4

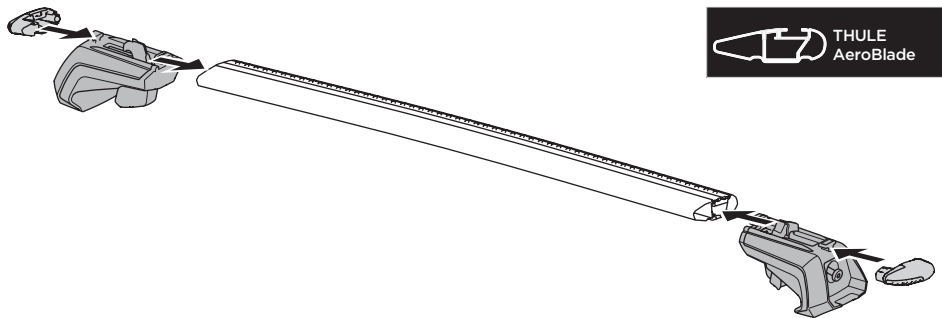

x2

 THULE  
SquareBar Evo

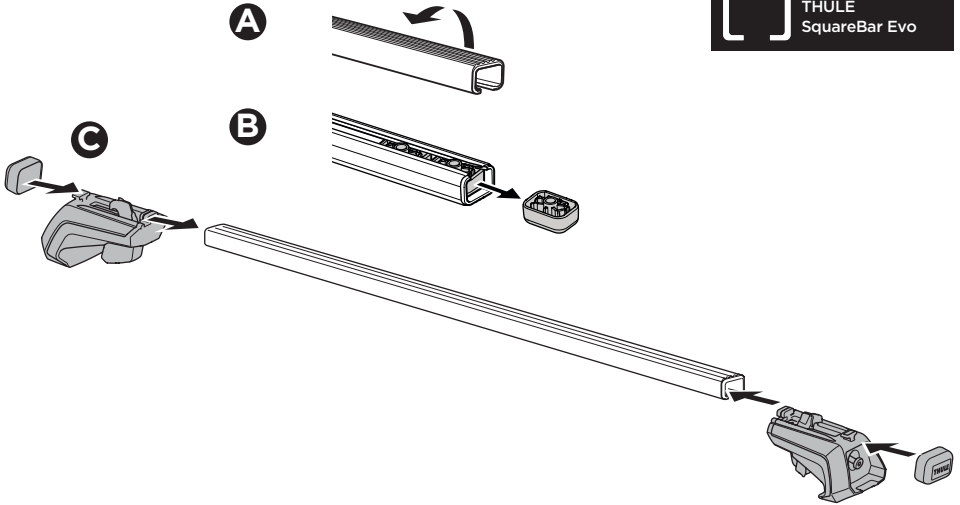

 THULE  
ProBar Evo

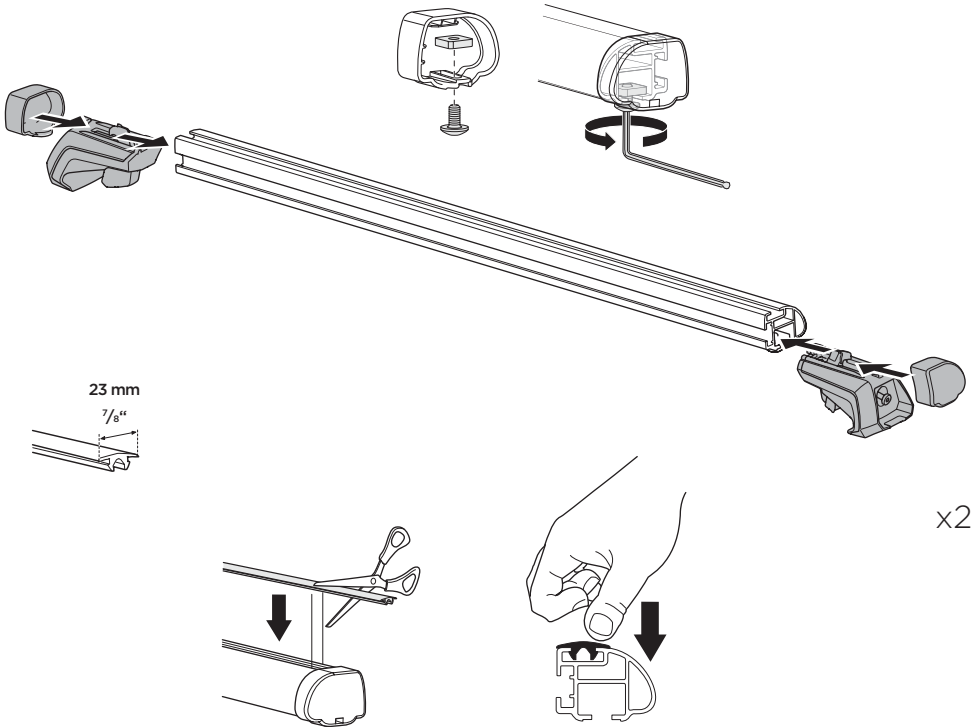

5

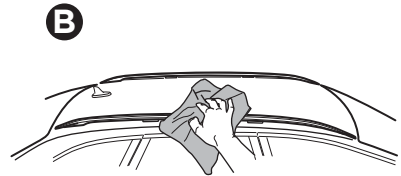
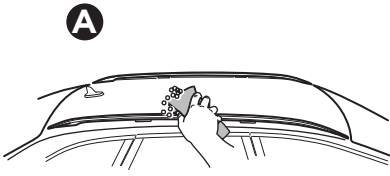

6

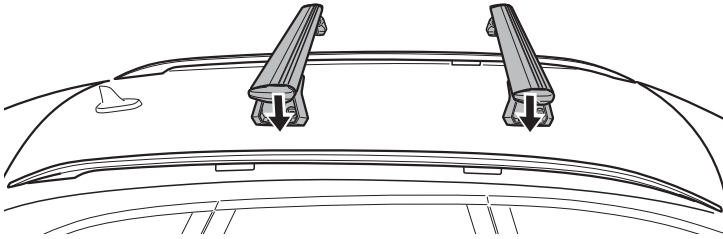

7

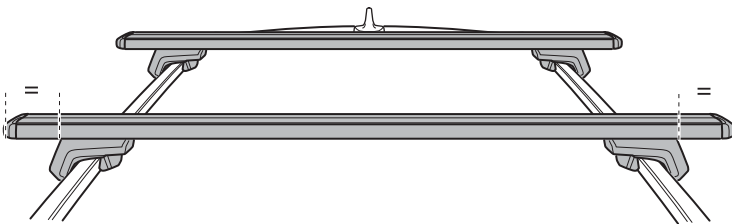
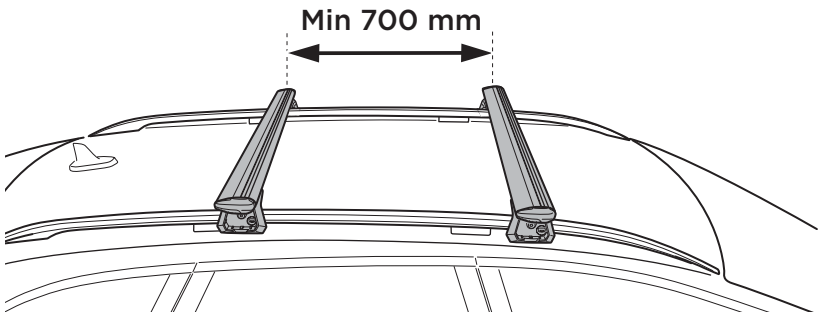



8

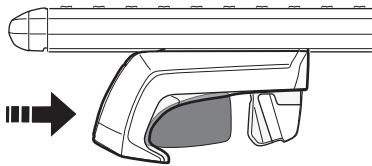
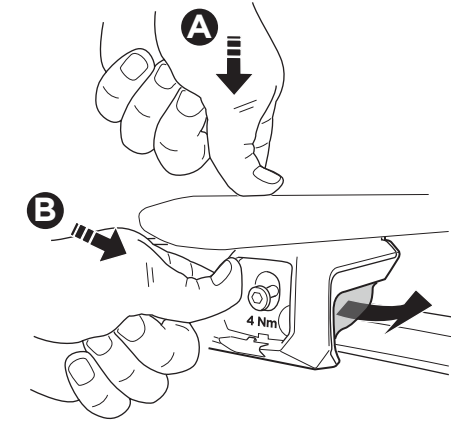

x4

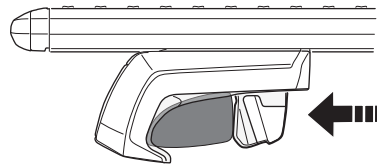
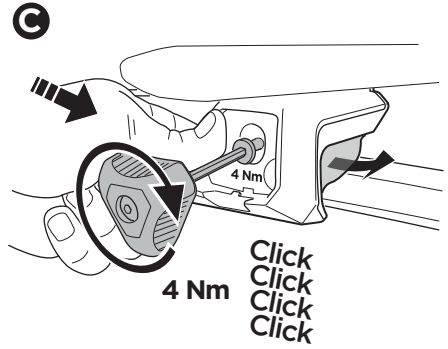

x4

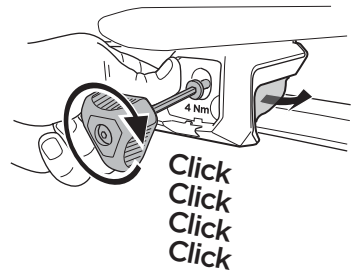
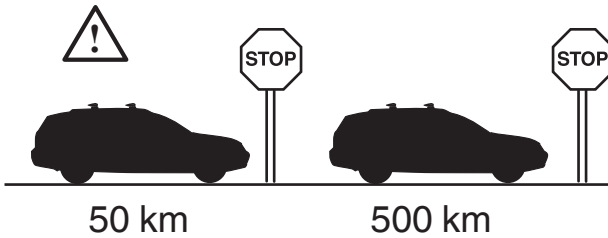
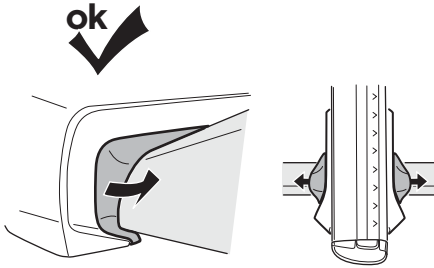

9

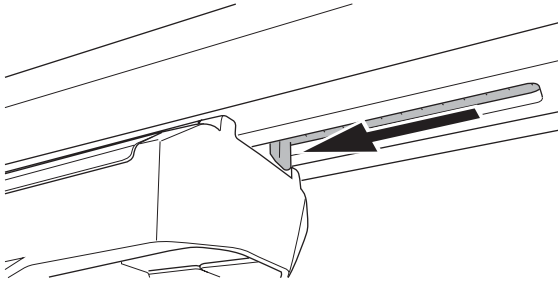

x4

10

A

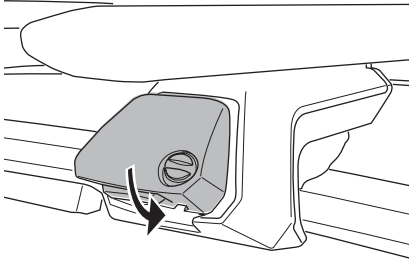

B

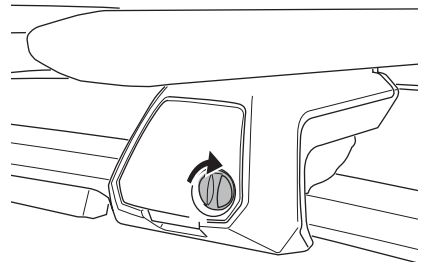

x4

**i** Accessory



A

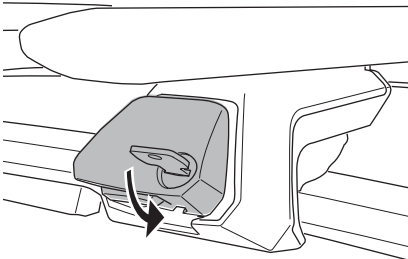

B

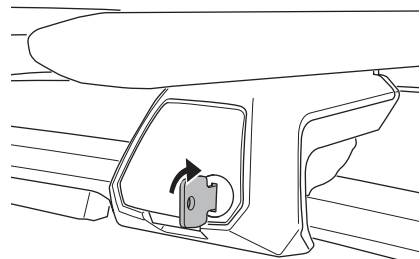

x4

11

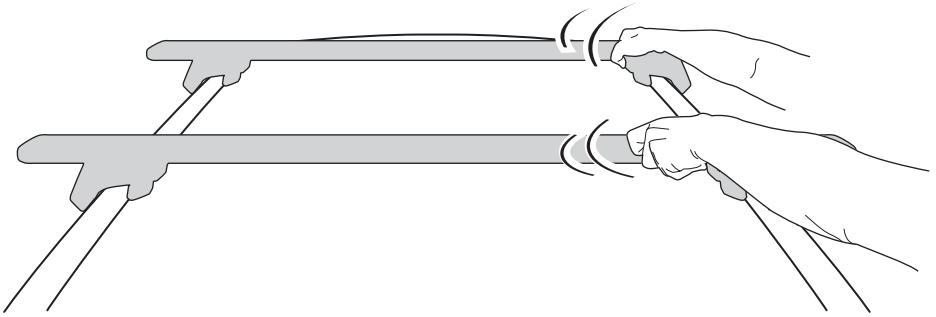

12

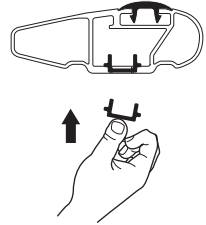
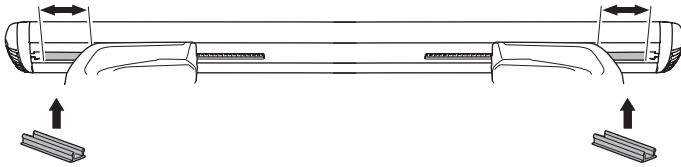
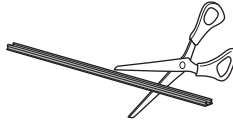

x4

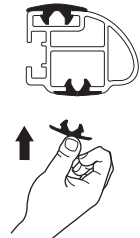
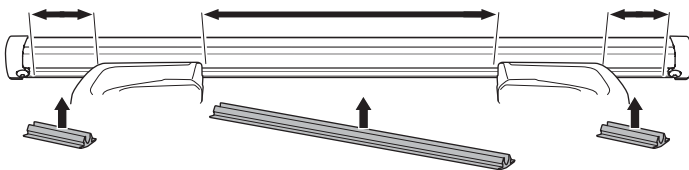
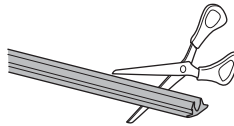
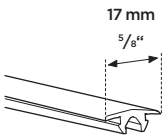

x2

**i**

